

LAND FOR SALE

94.54 SURVYED ACRES

LISTING #19068

CLINTON COUNTY, IA



DOUG YEGGE

C: 563.320.9900

O: 563.659.8185

Doug@PeoplesCompany.com

ALAN MCNEIL

C: 563.321.1125

O: 563.659.8185

Alan@PeoplesCompany.com

www.peoplescompany.co

PeoplesCompany.com

563.659.8185

700 6th Ave

DeWitt, Iowa 52742

LAND FOR SALE

LEGAL DESCRIPTION:

Being part of the North 1/2 of Section 9, Township 82 North, Range 5 East of the 5th P.M., Clinton County, Iowa. Exact legal description to come from the survey.

COMMENTS & BUILDING INFORMATION:

Peoples Company is excited to present an exceptional opportunity to acquire 94.54 surveyed acres of prime farmland in Clinton County, Iowa. This nearly 93% income-generating property features 87.48 FSA tillable acres. Boasting an impressive average CSR2 rating of 77.1, above the county average, this land is characterized by fertile Elvira and Colo loam soils.

Ideally located west of Clinton near Highway 30, the farm is in close proximity to ADM in Clinton, providing advantageous grain marketing opportunities. Over the years, extensive tile drainage has been installed in key areas to further enhance productivity and efficiency. Additionally, a wind turbine lease is in place, offering potential prospects for renewable energy development.

This property is conveniently situated just west of the "Elvira Blacktop" Z36 on 170th street, in Section 9 of Center Township, Clinton County, Iowa. Don't miss this chance to invest in a high-quality agricultural asset!

LEASE/FSA INFORMATION:

TO CONTACT LISTING AGENT:

Call: **Douglas R. Yegge**
 Cell: 563.320.9900
 Office: 563.659.8185
 Doug@PeoplesCompany.com

Call: **Alan McNeil**
 Cell: 563.321.1125
 Office: 563.659.8185
 Alan@peoplescompany.com

94.54 Surveyed Acres, Clinton County, IA

TOTAL ACRES:	94.54
PRICE:	\$1,181,750
Price Per Acre:	\$12,500
Owner:	Sterk
Operator:	
County & State:	Clinton Co., IA
Location:	5 miles southeast of Goose Lake, IA
Possession Date:	As agreed
Drainage Info:	Natural & Tile
Average Productivity:	77.1 CSR2
Taxable Acres:	91.44
Net RE Taxes:	\$4,356
Taxes Payable In:	2025
Topography:	Level

F.S.A. INFORMATION:

Farmland:	88.39
Crop Acres:	87.48
CRP Acres:	
Wheat Base:	
Wheat Yield:	
Corn Base:	87
Corn Yield:	157
Soybean Base:	
Soybean Yield:	

APPROXIMATE BREAKDOWN OF ACRES:

Total Acres:	94.54
Tillable Acres:	87.48
CRP Acres:	
Farmstead:	
Roads:	4
Non-tillable:	2.06
Timber:	
Pasture:	

PeoplesCompany.com
563.659.8185

700 6th Ave
 DeWitt, Iowa 52742

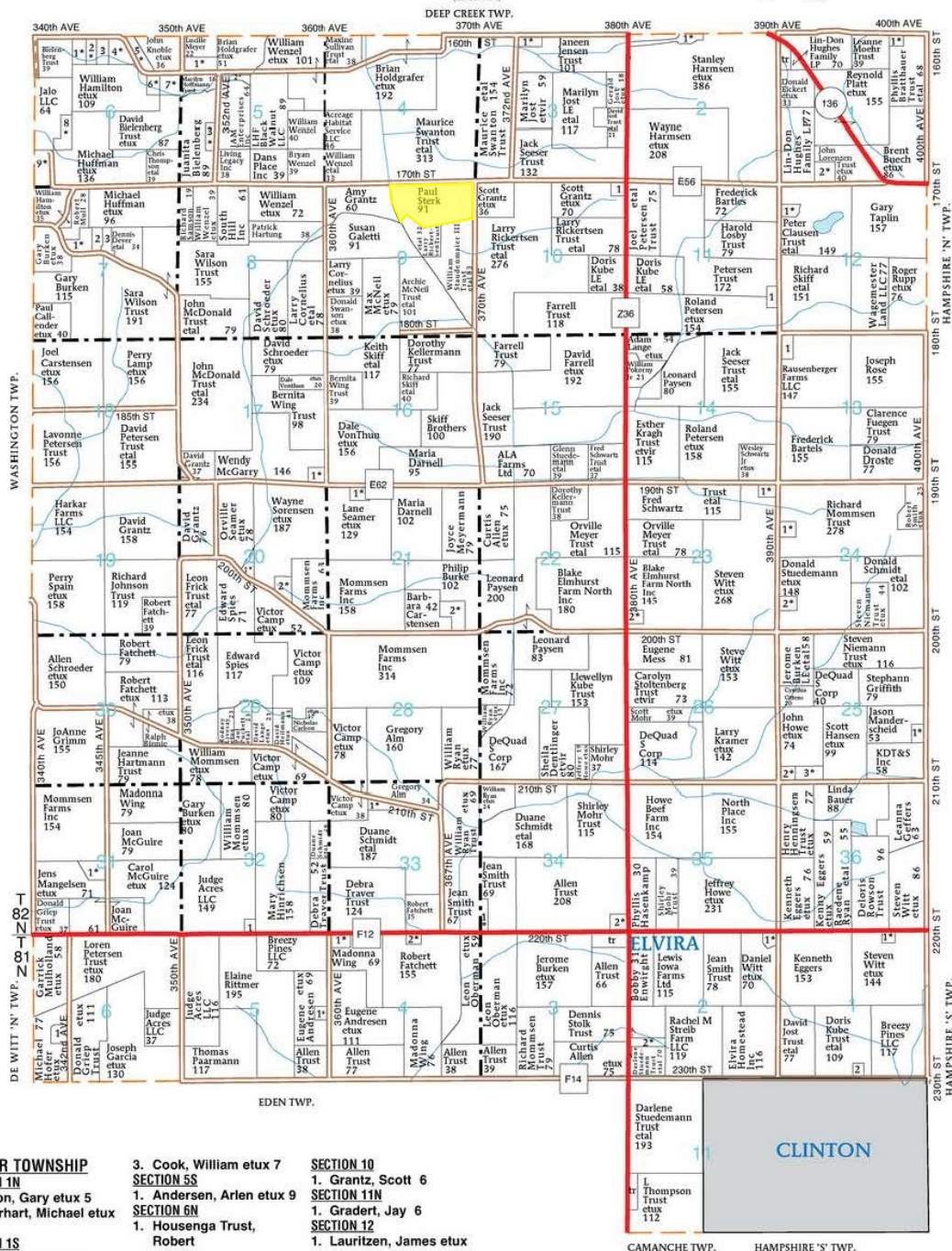

CENTER TOWNSHIP

SECTION 1N

1. Olson, Gary etux 5
2. Eberhart, Michael etux 10

SECTION 1S

1. Robertson, Clifford etux 9
2. Zarate, Raul 8

SECTION 2N

1. Voss, Mark etux 12

SECTION 2S

1. Boyd, Kevin etux 6
2. Munck, Curtis etux 6

SECTION 3N

1. Swanton, Joseph etux 9

SECTION 4S

1. Wullweber, Billy etux 8
2. Oberman Jr, Leon etux 5

SECTION 5N

1. Frame, Aaron etux 10
2. Mullin, James etux 12

SECTION 5S

1. Andersen, Arlen etux 9

SECTION 6N

1. Housenga Trust, Robert etux 10

SECTION 6S

1. Vawter, Michael etux 8
2. Stuit, James 11
3. Gluesing, John etal 13
5. Newsom, Joseph etux 13

SECTION 7N

1. Franks, Robert etux 9
2. Ganzer, Todd etux 13
3. Nash, Kirby etux 12
5. Grantz Trust, Marcella etux 10

SECTION 7S

1. Jurczyk, Andrew 13

SECTION 7

1. Rutledge, Clark etux 15
2. Edwards, Terry 9
3. Sledge, Michael 5

SECTION 10

1. Grantz, Scott 6

SECTION 11N

1. Gradert, Jay 6

SECTION 12

1. Lauritzen, James etux 7

SECTION 13

1. Gradert, Joan 9

SECTION 17

1. Arndt, Benjamin etux 6

SECTION 20

1. Richters, Bruce etux 6

SECTION 21

2. Petersen, Steven etux 7

SECTION 24

1. Briegel, Donald etux 7
2. Kroymann, David etux 15

SECTION 23

1. Krause, Keith etux 5
2. Gruhn, Travis etal 9

SECTION 24

1. Mommson, Matthew etal 9
2. Mommson, Matthew etal 8

SECTION 25

1. Elsasser, Craig etux 6
2. Jacobsen, Mark etux 8
3. Palmer, Louis etux 9

SECTION 31

1. Krogmann, Richard etux 7

SECTION 32

1. Koons, Martha 8

SECTION 33

1. Grimm, Kenny etux 6

SECTION 34

1. Burma, Brian etux 10
2. Smith, Richard etux 8

Aerial Map



©2026 AgriData, Inc.



DeWitt, Iowa | 563.659.8185

Maps Provided By:





© AgriData, Inc. 2025 www.AgriDataInc.com

Map Center: 41° 55' 47.08, -90° 22' 46.65

9-82N-5E
Clinton County
Iowa

0ft 660ft 1321ft





1/21/2026

Field borders provided by Farm Service Agency as of 5/21/2008.



STERK 94.54 A. (94.54 AC TOTAL, 87.48 AC TILLABLE)

TOTAL SOILS

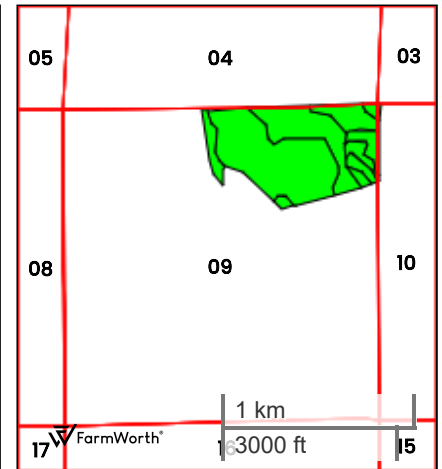
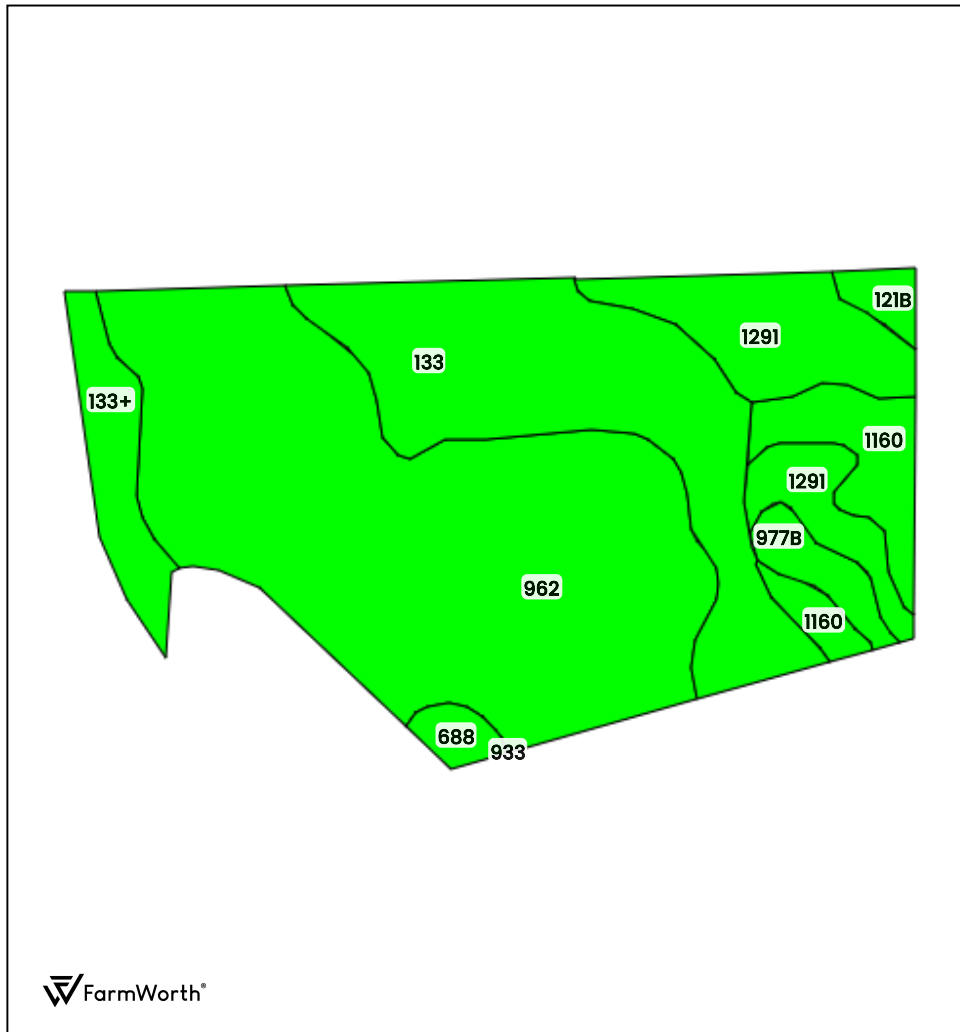

County: **Clinton County, IA**

Location: **09-82N-5E**

Township: **Center**

Acres: **94.54**

Date: **01/16/2026**



Field borders obtained from Farm Service Agency as of 2008

FarmWorth, LLC makes no representations or warranties, express or implied, as to the accuracy of any information, data, numerical values, boundaries, or any other information generated through the use of FarmWorth.com. User is solely responsible for independently investigating and determining all information provided through FarmWorth.com prior to use and waives any and all claims against FarmWorth, LLC for any inaccuracies or inconsistencies in the information and/or data.

Code	Description	Acres	% of field	IA CSR2
962	Elvira silty clay loam, 0 to 2 percent slopes, occasionally flooded	47.28	50.01 %	73
133	Colo silty clay loam, 0 to 2 percent slopes, occasionally flooded	21.21	22.43 %	78
1291	Atterberry silt loam, benches, 1 to 3 percent slopes	10.86	11.49 %	85
1160	Walford silt loam, benches, 0 to 1 percent slopes	5.87	6.21 %	85
133+	Colo silt loam, 0 to 2 percent slopes, occasionally flooded, overwash	4.70	4.97 %	78
977B	Richwood silt loam, 1 to 6 percent slopes	2.19	2.32 %	90
121B	Tama silt loam, driftless, 2 to 6 percent slopes	1.21	1.28 %	95
688	Koszta silt loam, 0 to 2 percent slopes	1.21	1.28 %	90
933	Sawmill silty clay loam, shallow loess, 0 to 2 percent slopes, occasionally flooded	0.01	0.01 %	78
Average:				77.4

IA has updated the CSR values for each county to CSR2.

Soils data provided by USDA and NRCS.



STERK 94.54 A. (94.54 AC TOTAL, 87.48 AC TILLABLE)

TILLABLE SOILS

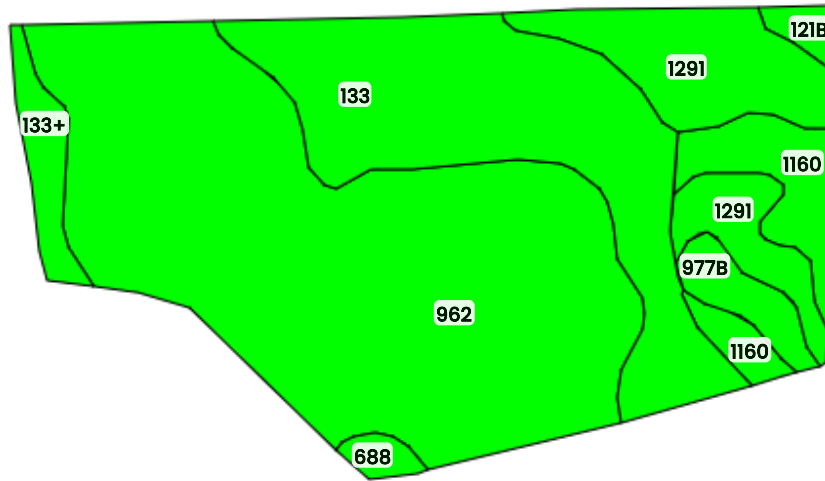

FarmWorth®

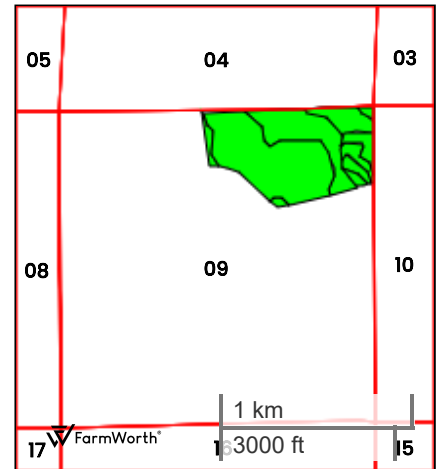

County: Clinton County, IA

Location: 09-82N-5E

Township: Center

Acres: 87.48

Date: 01/16/2026



Field borders obtained from Farm Service Agency
as of 2008

FarmWorth, LLC makes no representations or warranties, express or implied, as to the accuracy of any information, data, numerical values, boundaries, or any other information generated through the use of FarmWorth.com. User is solely responsible for independently investigating and determining all information provided through FarmWorth.com prior to use and waives any and all claims against FarmWorth, LLC for any inaccuracies or inconsistencies in the information and/or data.

Code	Description	Acres	% of field	IA CSR2
962	Elvira silty clay loam, 0 to 2 percent slopes, occasionally flooded	45.77	52.32 %	73
133	Colo silty clay loam, 0 to 2 percent slopes, occasionally flooded	20.47	23.40 %	78
1291	Atterberry silt loam, benches, 1 to 3 percent slopes	10.18	11.64 %	85
1160	Walford silt loam, benches, 0 to 1 percent slopes	5.00	5.72 %	85
133+	Colo silt loam, 0 to 2 percent slopes, occasionally flooded, overwash	2.37	2.71 %	78
977B	Richwood silt loam, 1 to 6 percent slopes	2.12	2.42 %	90
121B	Tama silt loam, driftless, 2 to 6 percent slopes	0.79	0.90 %	95
688	Koszta silt loam, 0 to 2 percent slopes	0.78	0.89 %	90
Average:				77.1

IA has updated the CSR values for each county to CSR2.

Soils data provided by USDA and NRCS.

subsurface drainage llc

spring of 2023
gooselake farm

Legend

- Feature 1
- Path

E56

170th St

a1 a2
a1

Google Earth

1000 ft

N



Subsurface Drainage LLC

paul: 563/357/2172
Deejay: 319/551/0609

Legend

- Feature 1
- Path

170th St

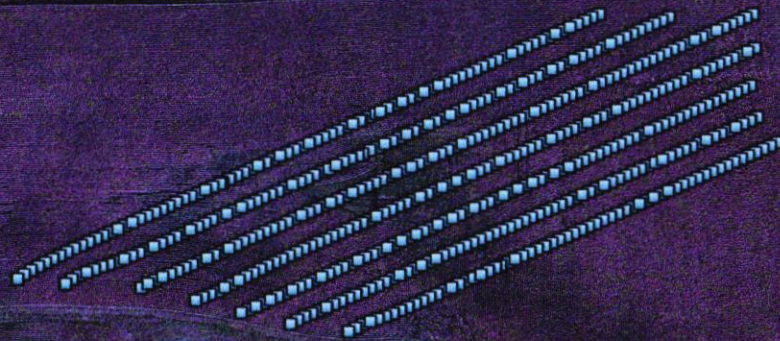

Google Earth

800 ft



SubSurface Drainage LLC

paul sterk 2018
gooselake farm

Legend

- Feature 1
- Path

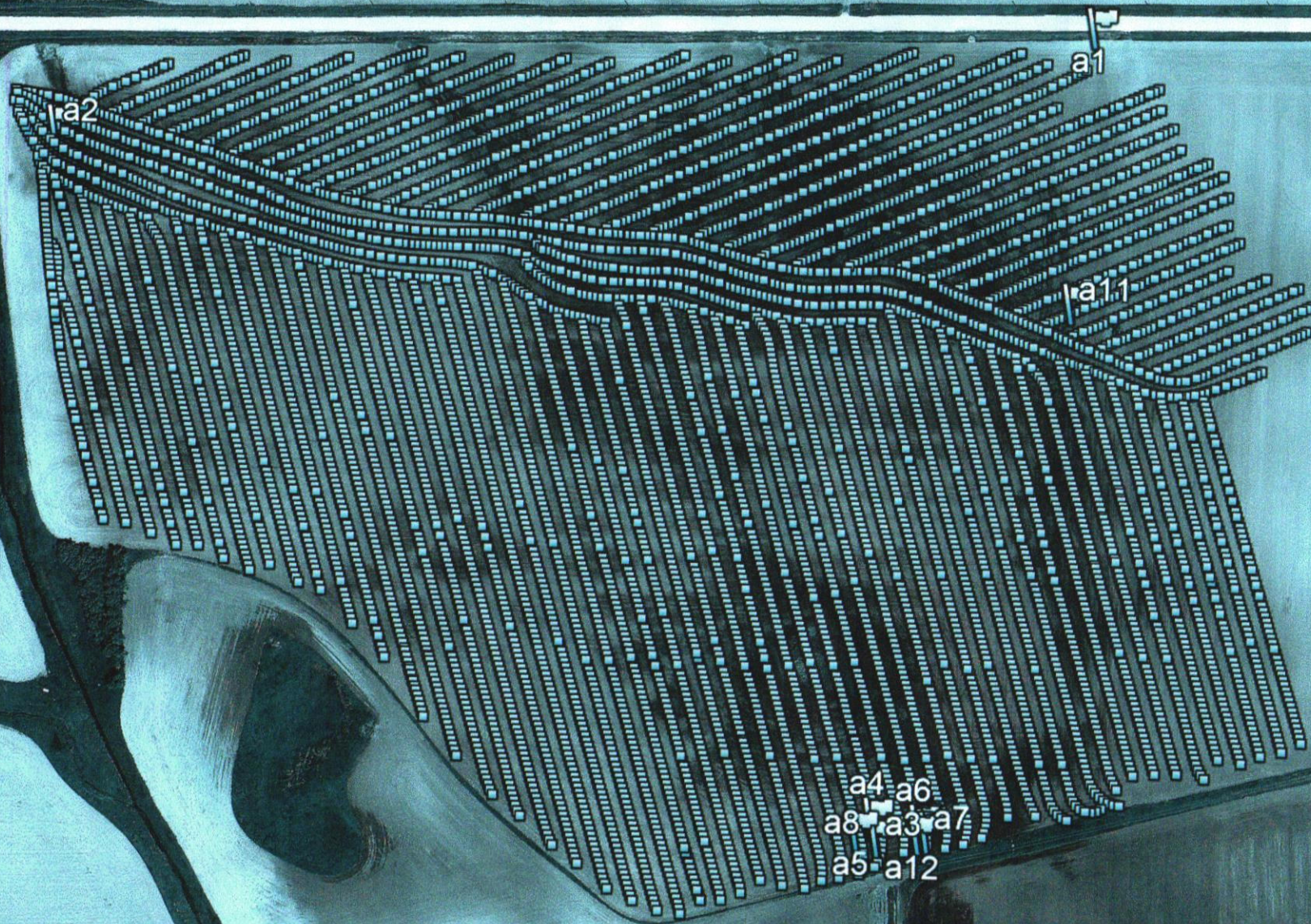

Google Earth

© 2018 Google

1000 ft





United States
Department of
Agriculture

Clinton County, Iowa



Legend

- | | | |
|--------------|----------------|------------|
| Non-Cropland | CRP | Iowa PLSS |
| Cropland | Tract Boundary | Iowa Roads |

Wetland Determination Identifiers

- Restricted Use
- Limited Restrictions
- Exempt from Conservation Compliance Provisions

Tract Cropland Total: 87.48 acres

2025 Program Year

Map Created April 16, 2025

Farm **8158**
Tract **13476**

United States Department of Agriculture (USDA) Farm Service Agency (FSA) maps are for FSA Program administration only. This map does not represent a legal survey or reflect actual ownership; rather it depicts the information provided directly from the producer and/or National Agricultural Imagery Program (NAIP) imagery. The producer accepts the data 'as is' and assumes all risks associated with its use. USDA-FSA assumes no responsibility for actual or consequential damage incurred as a result of any user's reliance on this data outside FSA Programs. Wetland identifiers do not represent the size, shape, or specific determination of the area. Refer to your original determination (CPA-026 and attached maps) for exact boundaries and determinations or contact USDA Natural Resources Conservation Service (NRCS).

USDA is an equal opportunity provider, employer, and lender.

IOWA
CLINTON

Form: FSA-156EZ

See Page 2 for non-discriminatory Statements.



United States Department of Agriculture
Farm Service Agency

Abbreviated 156 Farm Record

FARM : 8158

Prepared : 1/12/26 10:27 AM CST

Crop Year : 2026

Operator Name : NATHAN JOSEPH HARTUNG
CRP Contract Number(s) : None
Recon ID : 19-045-2018-63
Transferred From : None
ARCPLC G//F Eligibility : Eligible

Farm Land Data

Farmland	Cropland	DCP Cropland	WBP	EWP	WRP	GRP	Sugarcane	Farm Status	Number Of Tracts
88.39	87.48	87.48	0.00	0.00	0.00	0.00	0.0	Active	1
State Conservation	Other Conservation	Effective DCP Cropland	Double Cropped			CRP	MPL	DCP Ag.Rel. Activity	SOD
0.00	0.00	87.48	0.00			0.00	0.00	0.00	0.00

Crop Election Choice

ARC Individual	ARC County	Price Loss Coverage
None	CORN	None

DCP Crop Data

Crop Name	Base Acres	CCC-505 CRP Reduction Acres	PLC Yield	HIP
Corn	87.00	0.00	157	

TOTAL **87.00** **0.00**

NOTES

Tract Number : 13476

Description : NE1/4 of Sec 9, T82N,R5E
FSA Physical Location : IOWA/CLINTON
ANSI Physical Location : IOWA/CLINTON
BIA Unit Range Number :
CRP Contract Number(s) : None
HEL Status : NHEL: No agricultural commodity planted on undetermined fields
Wetland Status : Wetland determinations not complete
WL Violations : None
Owners : PAUL T STERK
Other Producers : None
Recon ID : 19-045-2018-62

Tract Land Data

Farm Land	Cropland	DCP Cropland	WBP	EWP	WRP	GRP	Sugarcane
88.39	87.48	87.48	0.00	0.00	0.00	0.00	0.0

IOWA
CLINTON

Form: FSA-156EZ



United States Department of Agriculture
Farm Service Agency

Abbreviated 156 Farm Record

FARM : 8158

Prepared : 1/12/26 10:27 AM CST

Crop Year : 2026

Tract 13476 Continued ...

State Conservation	Other Conservation	Effective DCP Cropland	Double Cropped	CRP	MPL	DCP Ag. Rel Activity	SOD
0.00	0.00	87.48	0.00	0.00	0.00	0.00	0.00

DCP Crop Data

Crop Name	Base Acres	CCC-505 CRP Reduction Acres	PLC Yield
Corn	87.00	0.00	157
TOTAL	87.00	0.00	

NOTES

In accordance with Federal civil rights law and U.S. Department of Agriculture (USDA) civil rights regulations and policies, the USDA, its Agencies, offices, and employees, and institutions participating in or administering USDA programs are prohibited from discriminating based on race, color, national origin, religion, sex, disability, age, marital status, family/parental status, income derived from a public assistance program, political beliefs, or reprisal or retaliation for prior civil rights activity, in any program or activity conducted or funded by USDA (not all bases apply to all programs). Remedies and complaint filing deadlines vary by program or incident.

Persons with disabilities who require alternative means of communication for program information (e.g., Braille, large print, audiotope, American Sign Language, etc.) should contact the State or Local Agency that administers the program or contact USDA through the Telecommunications Relay Service at 711 (voice and TTY). Additionally, program information may be made available in languages other than English.

To file a program discrimination complaint, complete the USDA Program Discrimination Complaint Form, AD-3027, found online at [How to File a Program Discrimination Complaint](#) and at any USDA office or write a letter addressed to USDA and provide in the letter all of the information requested in the form. To request a copy of the complaint form, call (866) 632-9992. Submit your completed form or letter to USDA by: (1) Mail: U.S. Department of Agriculture Office of the Assistant Secretary for Civil Rights, 1400 Independence Avenue, SW Washington, D.C. 20250-9410; (2) Fax: (202) 690-7442; or (3) Email: program.intake@usda.gov. USDA is an equal opportunity provider, employer, and lender.

PLAT OF SURVEY
BEING PART OF THE N. 1/2 OF SECTION 9 AND
PART OF N.W. 1/4 OF THE N.W. 1/4 OF
SECTION 10, TOWNSHIP-82 NORTH, RANGE-5 EAST
OF THE 5TH P.M., CLINTON COUNTY, IOWA

PARCEL "B" DESCRIPTION:

BEING A PART OF THE NORTHWEST QUARTER OF THE NORTHWEST QUARTER OF SECTION 10, TOWNSHIP 82 NORTH, RANGE 5 EAST OF THE 5TH P.M., CLINTON COUNTY, IOWA, MORE PARTICULARLY DESCRIBED AS FOLLOWS:
BEGINNING AT THE SOUTHWEST CORNER OF THE NORTHWEST QUARTER OF THE NORTHWEST QUARTER OF SECTION 10; THENCE NORTH 01° 13' 15" EAST, 973.93 FEET ALONG THE WEST LINE OF THE NORTHWEST QUARTER OF THE NORTHWEST QUARTER OF SECTION 10; THENCE NORTH 89° 59' 00" EAST, 375.13 FEET; THENCE NORTH 00° 21' 32" EAST, 348.48 FEET TO THE NORTH LINE OF THE NORTHWEST QUARTER OF THE NORTHWEST QUARTER OF SECTION 10; THENCE NORTH 89° 57' 54" EAST, 944.46 FEET ALONG THE NORTH LINE OF THE NORTHWEST QUARTER OF THE NORTHWEST QUARTER OF SECTION 10 TO THE NORTHEAST CORNER OF THE NORTHWEST QUARTER OF THE NORTHWEST QUARTER OF SECTION 10; THENCE SOUTH 00° 14' 43" WEST, 1316.21 FEET ALONG THE EAST LINE OF THE NORTHWEST QUARTER OF THE NORTHWEST QUARTER OF SECTION 10 TO THE SOUTHEAST CORNER OF THE NORTHWEST QUARTER OF THE NORTHWEST QUARTER OF SECTION 10; THENCE SOUTH 89° 42' 56" WEST, 1336.91 FEET ALONG THE SOUTH LINE OF THE NORTHWEST QUARTER OF THE NORTHWEST QUARTER OF SECTION 10 TO THE POINT OF BEGINNING.
SAID PARCEL CONTAINS 37.16 ACRES AND IS SUBJECT TO EASEMENTS OF RECORD.

PARCEL "C" DESCRIPTION:

BEING A PART OF THE NORTH ONE-HALF OF SECTION 9, TOWNSHIP 82 NORTH, RANGE 5 EAST OF THE 5TH P.M., CLINTON COUNTY, IOWA, MORE PARTICULARLY DESCRIBED AS FOLLOWS:
BEGINNING AT THE NORTHEAST CORNER OF SECTION 9; THENCE SOUTH 00° 23' 17" WEST, 348.32 FEET ALONG THE EAST LINE OF THE NORTHEAST QUARTER OF THE NORTHEAST QUARTER OF SECTION 9; THENCE SOUTH 01° 13' 15" WEST, 973.93 FEET ALONG THE EAST LINE OF THE NORTHEAST QUARTER OF THE NORTHEAST QUARTER OF SECTION 9 TO THE SOUTHEAST CORNER OF THE NORTHEAST QUARTER OF THE NORTHEAST QUARTER OF SECTION 9;
THENCE SOUTH 74° 58' 21" WEST, 1701.05 FEET ALONG THE PUBLIC HIGHWAY;
THENCE NORTH 48° 31' 39" WEST, 869.22 FEET ALONG THE PUBLIC HIGHWAY;
THENCE NORTH 73° 46' 39" WEST, 201.30 FEET ALONG THE PUBLIC HIGHWAY;
THENCE SOUTH 89° 00' 56" WEST, 156.64 FEET ALONG THE PUBLIC HIGHWAY TO THE WEST LINE OF THE NORTHWEST QUARTER OF THE NORTHEAST QUARTER OF SECTION 9; THENCE SOUTH 00° 17' 35" WEST, 266.06 FEET ALONG THE EAST LINE OF THE NORTHEAST QUARTER OF THE NORTHWEST QUARTER OF SECTION 9 TO THE SOUTHEAST CORNER OF THE NORTHEAST QUARTER OF THE NORTHWEST QUARTER OF SECTION 9;
THENCE NORTH 30° 05' 07" WEST, 257.62 FEET ALONG THE CENTERLINE OF A DRAINAGE DITCH; THENCE NORTH 21° 08' 15" WEST, 234.50 FEET ALONG THE CENTERLINE OF A DRAINAGE DITCH;
THENCE NORTH 08° 06' 08" WEST, 887.92 FEET ALONG THE CENTERLINE OF A DRAINAGE DITCH TO THE NORTH LINE OF SECTION 9; THENCE NORTH 88° 29' 26" EAST, 3008.38 FEET ALONG THE NORTH LINE OF SECTION 9 TO THE POINT OF BEGINNING. SAID PARCEL CONTAINS 94.54 ACRES AND IS SUBJECT TO EASEMENTS OF RECORD.

PARCEL "D" DESCRIPTION

BEING A PART OF THE NORTH ONE-HALF OF THE NORTHWEST QUARTER OF SECTION 9, TOWNSHIP 82 NORTH, RANGE 5 EAST OF THE 5TH P.M., CLINTON COUNTY, IOWA, MORE PARTICULARLY DESCRIBED AS FOLLOWS:
BEGINNING AT THE NORTHWEST CORNER OF SECTION 9; THENCE NORTH 88° 29' 26" EAST, 2316.85 FEET ALONG THE NORTH LINE OF SECTION 9 TO THE CENTERLINE OF A DRAINAGE DITCH; THENCE SOUTH 08° 06' 08" EAST, 887.92 FEET ALONG THE CENTERLINE OF A DRAINAGE DITCH; THENCE SOUTH 21° 08' 15" EAST, 234.50 FEET ALONG THE CENTERLINE OF A DRAINAGE DITCH; THENCE SOUTH 30° 05' 07" EAST, 257.62 FEET ALONG THE CENTERLINE OF A DRAINAGE DITCH TO THE SOUTHEAST CORNER OF THE NORTHEAST QUARTER OF THE NORTHWEST QUARTER OF SECTION 9;
THENCE SOUTH 88° 18' 48" WEST, 64.21 FEET ALONG THE SOUTH LINE OF THE NORTHEAST QUARTER OF THE NORTHWEST QUARTER OF SECTION 9 TO THE NORTH BANK OF THE CREEK;
THENCE NORTH 56° 29' 56" WEST, 145.81 FEET ALONG THE NORTH BANK OF THE CREEK;
THENCE NORTH 85° 04' 33" WEST, 235.10 FEET ALONG THE NORTH BANK OF THE CREEK;
THENCE NORTH 76° 57' 50" WEST, 637.11 FEET ALONG THE NORTH BANK OF THE CREEK;
THENCE NORTH 80° 33' 36" WEST, 146.41 FEET ALONG THE NORTH BANK OF THE CREEK;
THENCE SOUTH 88° 33' 07" WEST, 114.20 FEET ALONG THE NORTH BANK OF THE CREEK;
THENCE NORTH 78° 50' 30" WEST, 111.69 FEET ALONG THE NORTH BANK OF THE CREEK;
THENCE SOUTH 85° 04' 21" WEST, 114.37 FEET ALONG THE NORTH BANK OF THE CREEK;
THENCE SOUTH 65° 12' 14" WEST, 121.95 FEET ALONG THE NORTH BANK OF THE CREEK;
THENCE SOUTH 83° 12' 33" WEST, 92.49 FEET ALONG THE NORTH BANK OF THE CREEK;
THENCE NORTH 87° 33' 01" WEST, 143.07 FEET ALONG THE NORTH BANK OF THE CREEK;
THENCE NORTH 77° 25' 55" WEST, 178.08 FEET ALONG THE NORTH BANK OF THE CREEK;
THENCE SOUTH 77° 24' 12" WEST, 59.60 FEET ALONG THE NORTH BANK OF THE CREEK;
THENCE SOUTH 69° 16' 41" WEST, 106.68 FEET ALONG THE NORTH BANK OF THE CREEK;
THENCE NORTH 86° 09' 51" WEST, 66.40 FEET ALONG THE NORTH BANK OF THE CREEK;
THENCE SOUTH 64° 19' 14" WEST, 63.84 FEET ALONG THE NORTH BANK OF THE CREEK;
THENCE SOUTH 44° 22' 15" WEST, 68.96 FEET ALONG THE NORTH BANK OF THE CREEK;
THENCE SOUTH 01° 38' 28" WEST, 49.34 FEET ALONG THE NORTH BANK OF THE CREEK;
THENCE SOUTH 28° 15' 38" EAST, 57.68 FEET ALONG THE NORTH BANK OF THE CREEK;
THENCE SOUTH 13° 59' 49" EAST, 81.17 FEET ALONG THE NORTH BANK OF THE CREEK;
THENCE SOUTH 61° 22' 37" WEST, 131.57 FEET ALONG THE NORTH BANK OF THE CREEK;
THENCE SOUTH 72° 23' 53" WEST, 80.62 FEET ALONG THE NORTH BANK OF THE CREEK;
THENCE SOUTH 88° 25' 15" WEST, 132.50 FEET ALONG THE NORTH BANK OF THE CREEK TO THE WEST LINE OF THE SOUTHWEST QUARTER OF THE NORTHWEST QUARTER OF SECTION 9;
THENCE NORTH 00° 08' 32" WEST, 56.93 FEET ALONG THE WEST LINE OF THE SOUTHWEST QUARTER OF THE NORTHWEST QUARTER OF SECTION 9 TO THE SOUTHWEST CORNER OF THE NORTHWEST QUARTER OF THE NORTHWEST QUARTER OF SECTION 9;
THENCE NORTH 00° 08' 51" WEST, 1337.74 FEET ALONG THE WEST LINE OF THE NORTHWEST QUARTER OF THE NORTHWEST QUARTER OF SECTION 9 TO THE POINT OF BEGINNING. SAID PARCEL CONTAINS 62.56 ACRES AND IS SUBJECT TO EASEMENTS OF RECORD

LOCATION: N.W. 1/4 SEC. 10,
N. 1/2 SEC. 9

FOR/ OWNER: AMY DIERKS TRUST
4440 W. 60th STREET
DAVENPORT, IA. 52806

PREPARED BY: DOUGLAS M. HINKLE
HINKLE ENGINEERING & SURVEYING
2100 CAMACHE AVE.
CLINTON, IA. 52732
PHONE (563) 243-4027
FAX (563) 243-4029
Project Name: DIERKS FARM SURVEY 3
Project #: 17-1910



I HEREBY CERTIFY THAT THIS LAND SURVEYING DOCUMENT WAS PREPARED AND THE RELATED SURVEY WORK WAS PERFORMED BY ME OR UNDER MY DIRECT PERSONAL SUPERVISION AND THAT I AM A DULY LICENSED LAND SURVEYOR UNDER THE LAWS OF THE STATE OF IOWA.

D. M. Hinkle DATE: 8/25/2017

DOUGLAS M. HINKLE, L.L.S. IOWA REG. NO. 18875
MY LICENSE RENEWAL DATE IS DECEMBER 31, 2017
PAGES OR SHEETS COVERED BY THIS SEAL, SHEET 2 OF 2

PLAT OF SURVEY

BEING PART OF THE N. 1/2 OF SECTION 9 AND
PART OF N.W. 1/4 OF THE N.W. 1/4 OF
SECTION 10, TOWNSHIP-82 NORTH, RANGE-5 EAST
OF THE 5TH P.M., CLINTON COUNTY, IOWA

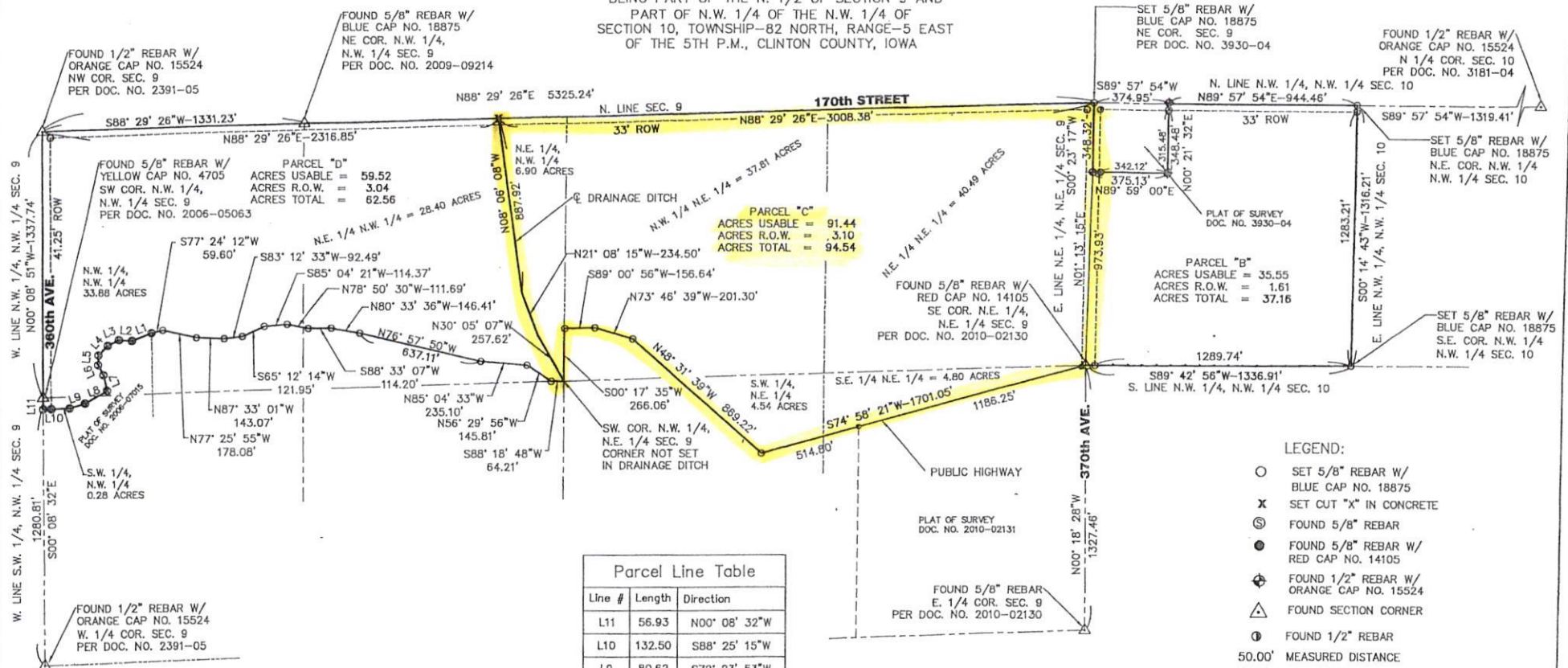

Parcel Line Table		
Line #	Length	Direction
L11	56.93	N00° 08' 32"W
L10	132.50	S88° 25' 15"W
L9	80.62	S72° 23' 53"W
L8	131.57	S61° 22' 37"W
L7	81.17	S13° 59' 49"E
L6	57.68	S28° 15' 38"E
L5	49.34	S01° 38' 28"W
L4	68.96	S44° 22' 15"W
L3	63.84	S64° 19' 14"W
L2	66.40	N86° 09' 51"W
L1	106.68	S69° 15' 41"W

D. M. Hinkle DATE: 8/25/2017
DOUGLAS M. HINKLE, L.L.S. IOWA REG. NO. 18875
MY LICENSE RENEWAL DATE IS DECEMBER 31, 2017
PAGES OR SHEETS COVERED BY THIS SEAL, SHEET 1 OF 2

LEGEND:

- SET 5/8" REBAR W/
BLUE CAP NO. 18875
- X SET CUT "X" IN CONCRETE
- ⊙ FOUND 5/8" REBAR
- FOUND 5/8" REBAR W/
RED CAP NO. 14105
- ⊕ FOUND 1/2" REBAR W/
ORANGE CAP NO. 15524
- △ FOUND SECTION CORNER
- ① FOUND 1/2" REBAR

50.00'
(50') MEASURED DISTANCE
DEED OR PLATTED DISTANCE

PARCEL "C" DESCRIPTION:

BEING A PART OF THE NORTH ONE-HALF OF SECTION 9, TOWNSHIP 82 NORTH, RANGE 5 EAST OF THE 5TH P.M, CLINTON COUNTY, IOWA, MORE PARTICULARLY DESCRIBED AS FOLLOWS:

BEGINNING AT THE NORTHEAST CORNER OF SECTION 9; THENCE SOUTH 00° 23' 17" WEST, 348.32 FEET ALONG THE EAST LINE OF THE NORTHEAST QUARTER OF THE NORTHEAST QUARTER OF SECTION 9; THENCE SOUTH 01° 13' 15" WEST, 973.93 FEET ALONG THE EAST LINE OF THE NORTHEAST QUARTER OF THE NORTHEAST QUARTER OF SECTION 9 TO THE SOUTHEAST CORNER OF THE NORTHEAST QUARTER OF THE NORTHEAST QUARTER OF SECTION 9;

THENCE SOUTH 74° 58' 21" WEST, 1701.05 FEET ALONG THE PUBLIC HIGHWAY;

THENCE NORTH 48° 31' 39" WEST, 869.22 FEET ALONG THE PUBLIC HIGHWAY;

THENCE NORTH 73° 46' 39" WEST, 201.30 FEET ALONG THE PUBLIC HIGHWAY;

THENCE SOUTH 89° 00' 56" WEST, 156.64 FEET ALONG THE PUBLIC HIGHWAY TO THE WEST LINE OF THE NORTHWEST QUARTER OF THE NORTHEAST QUARTER OF SECTION 9; THENCE SOUTH 00° 17' 35" WEST, 266.06 FEET ALONG THE EAST LINE OF NORTHEAST QUARTER OF THE NORTHWEST QUARTER OF SECTION 9 TO THE SOUTHEAST CORNER OF THE NORTHEAST QUARTER OF THE NORTHWEST QUARTER OF SECTION 9; THENCE NORTH 30° 05' 07" WEST, 257.62 FEET ALONG THE CENTERLINE OF A DRAINAGE DITCH; THENCE NORTH 21° 08' 15" WEST, 234.50 FEET ALONG THE CENTERLINE OF A DRAINAGE DITCH;

THENCE NORTH 08° 06' 08" WEST, 887.92 FEET ALONG THE CENTERLINE OF A DRAINAGE DITCH TO THE NORTH LINE OF SECTION 9; THENCE NORTH 88° 29' 26" EAST, 3008.38 FEET ALONG THE NORTH LINE OF SECTION 9 TO THE POINT OF BEGINNING. SAID PARCEL CONTAINS 94.54 ACRES AND IS SUBJECT TO EASEMENTS OF RECORD.